



at St. Elizabeths

# WELCOME

to the Public Scoping Meeting for the

Department of Homeland Security  
Headquarters Consolidation  
at St. Elizabeths

**Master Plan Amendment #2**

September 29, 2016



# Project Location

The St. Elizabeths West Campus is:

- Located in Southeast Washington, DC
- Bounded by I-295 to the West,
- Barry Farm Community to the North
- Martin Luther King Jr. Avenue and the St. Elizabeths East Campus to the East
- The Shepherd Parkway and Congress Heights Neighborhood to the South



Department of Homeland Security Headquarters  
at St. Elizabeths

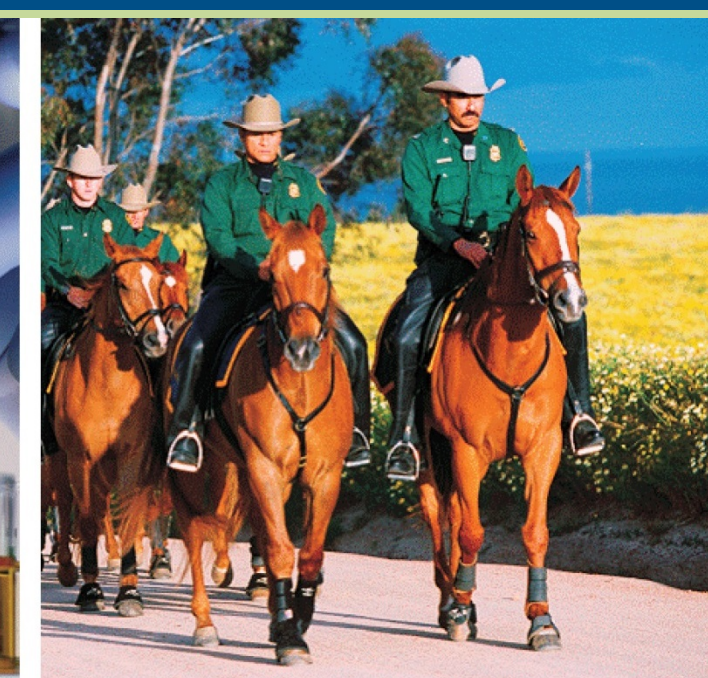



# Proposed Action

- Amend the 2012 Department of Homeland Security (DHS) Headquarters Consolidation at St. Elizabeths Master Plan
- Consolidate DHS operating components on the St. Elizabeths West Campus
- Reevaluate transportation and parking improvements for the consolidation



Department of Homeland Security Headquarters  
at St. Elizabeths

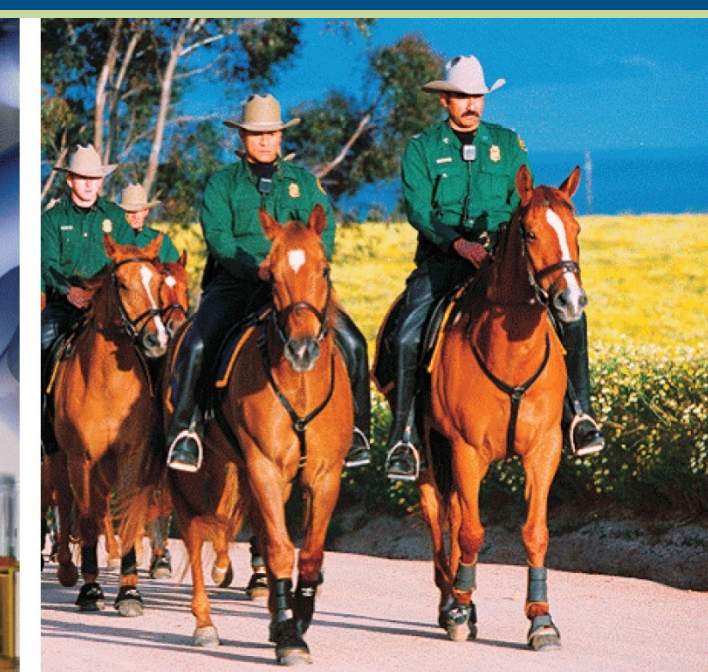



# Purpose and Need

- The purpose of the proposed action is to revise the DHS Headquarters Consolidation at St. Elizabeths Master Plan
- The proposed action is needed to reduce costs and to shorten the duration of construction so that the Department of Homeland Security (DHS) Headquarters can occupy the campus in a timely manner



Department of Homeland Security Headquarters  
at St. Elizabeths





# Proposed Master Plan Amendment #2

## 2016 MASTER PLAN AMENDMENT #2 | AREAS UNDER REVIEW

### LEGEND

- Adaptive reuse
- New construction
- Areas under review

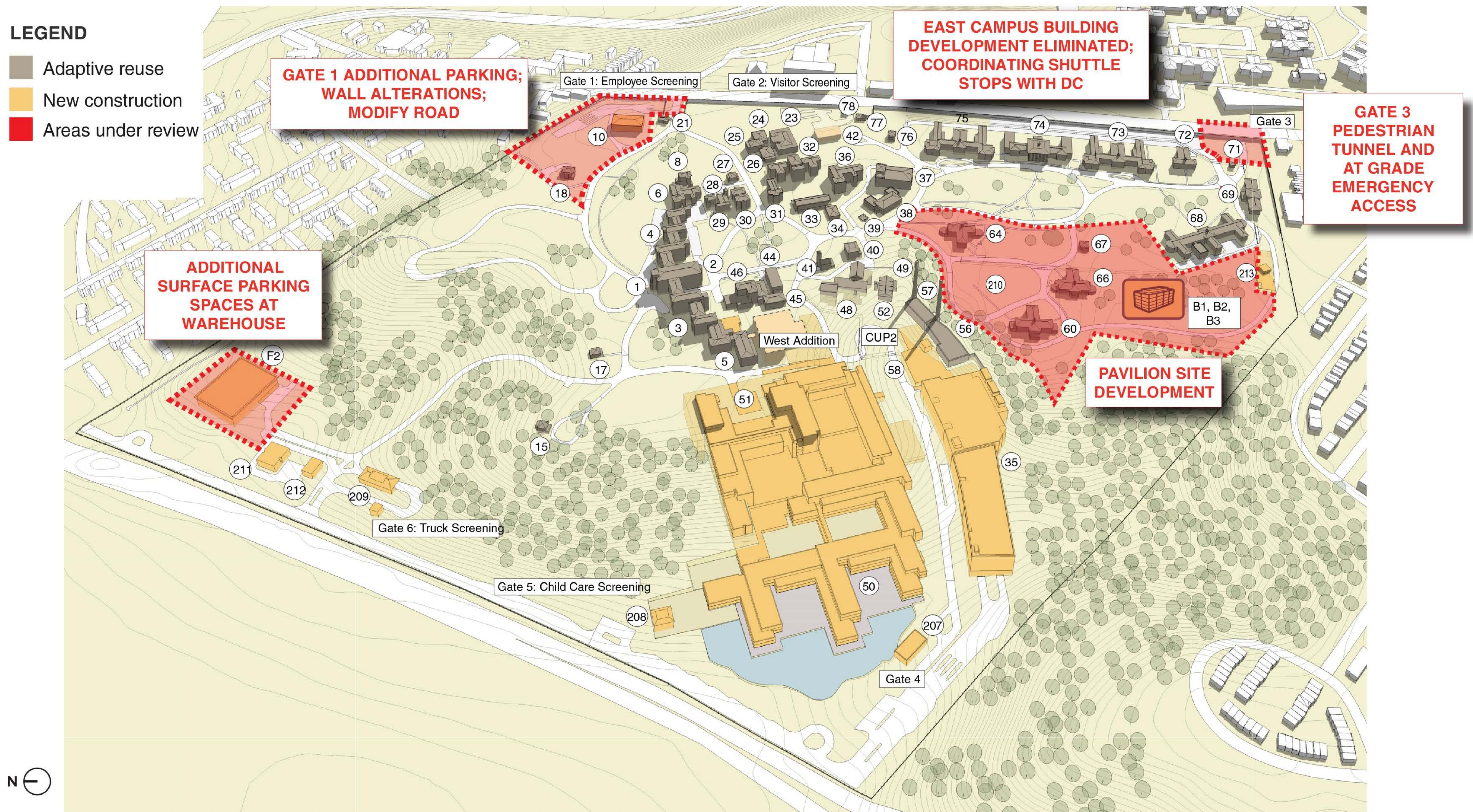

Department of Homeland Security Headquarters  
at St. Elizabeths





# National Environmental Policy Act Process

per the Council on Environmental Regulations (40 CFR 1500-1508)

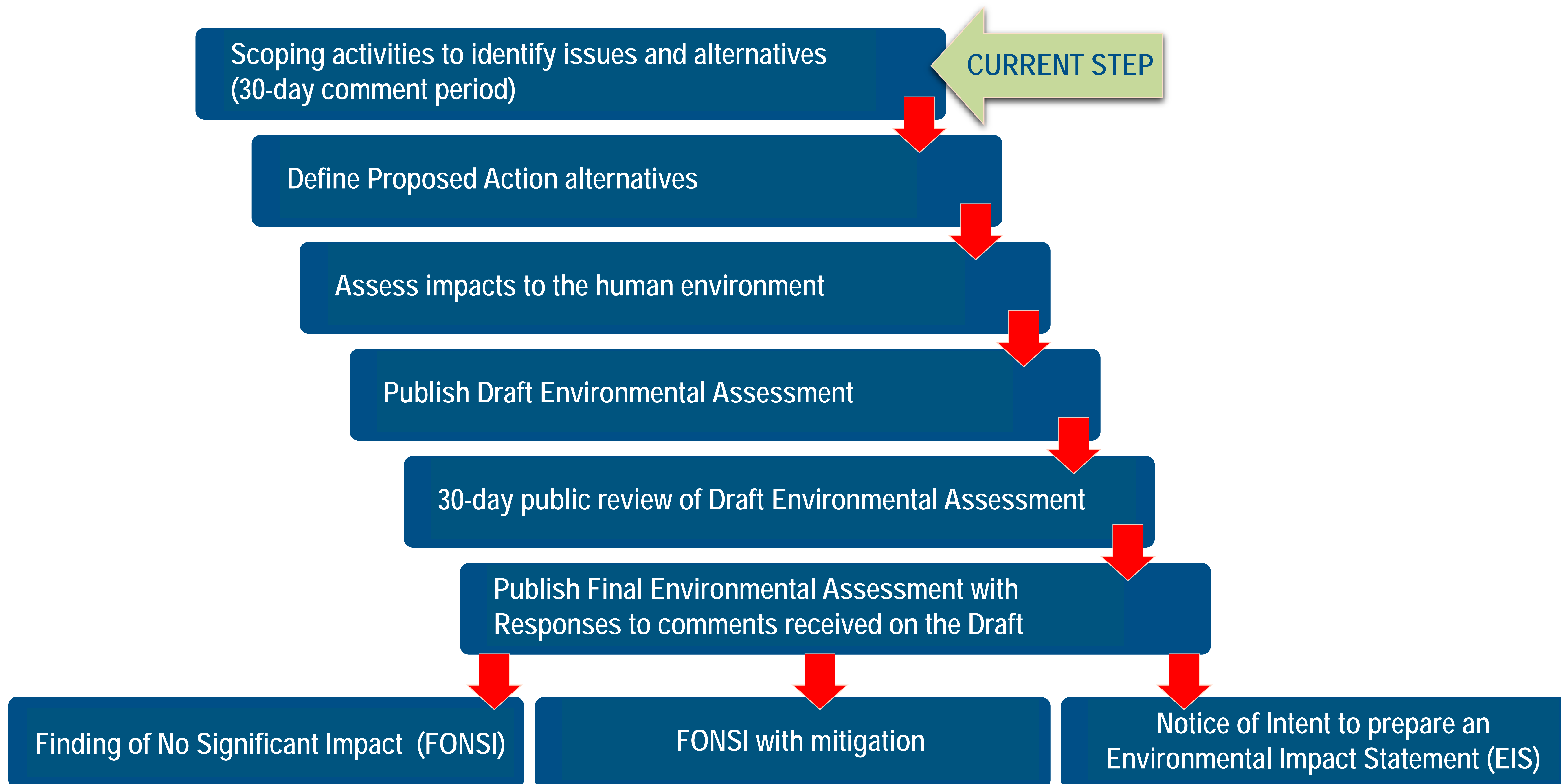

Department of Homeland Security Headquarters  
at St. Elizabeths





# National Historic Preservation Act

## Section 106 Process

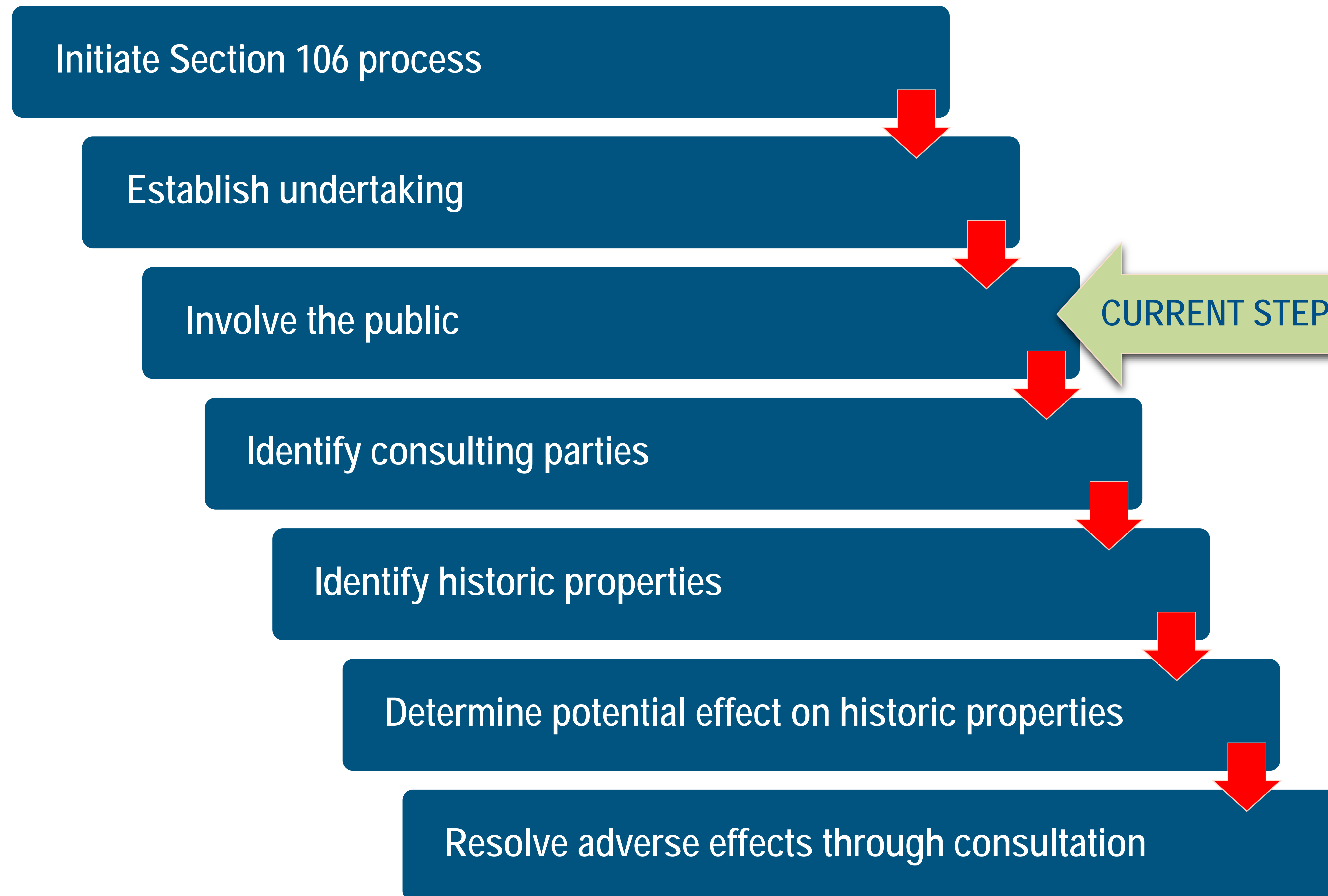

Department of Homeland Security Headquarters  
at St. Elizabeths





# Topics for Study under NEPA & NHPA

- Transportation and parking
- Historic buildings
- Historic landscapes
- Significant viewsheds
- Potential below ground resources (archaeology)
- Geology, soils, and topography
- Water resources
- Vegetation and wildlife
- Hazardous materials
- Air quality
- Noise
- Land use planning
- Economic conditions
- Environmental justice
- Community facilities and service
- Utilities
- Pedestrian circulation



Department of Homeland Security Headquarters  
at St. Elizabeths

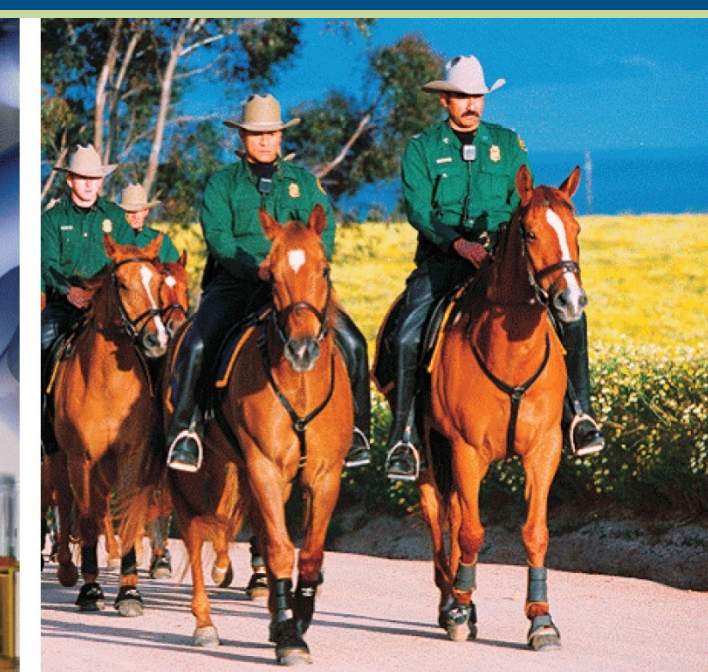



# St. Elizabeths West Campus Development

## Illustrative Site Plan

### PROJECT STATUS:

- ## Project completed
- ## Project underway
- ## Project forthcoming

### ROADWAY IMPROVEMENT PROJECTS:

- A Firth Sterling intersection
- B On-site Access Road
- C I-295/Malcolm X Interchange
- D MLK widening

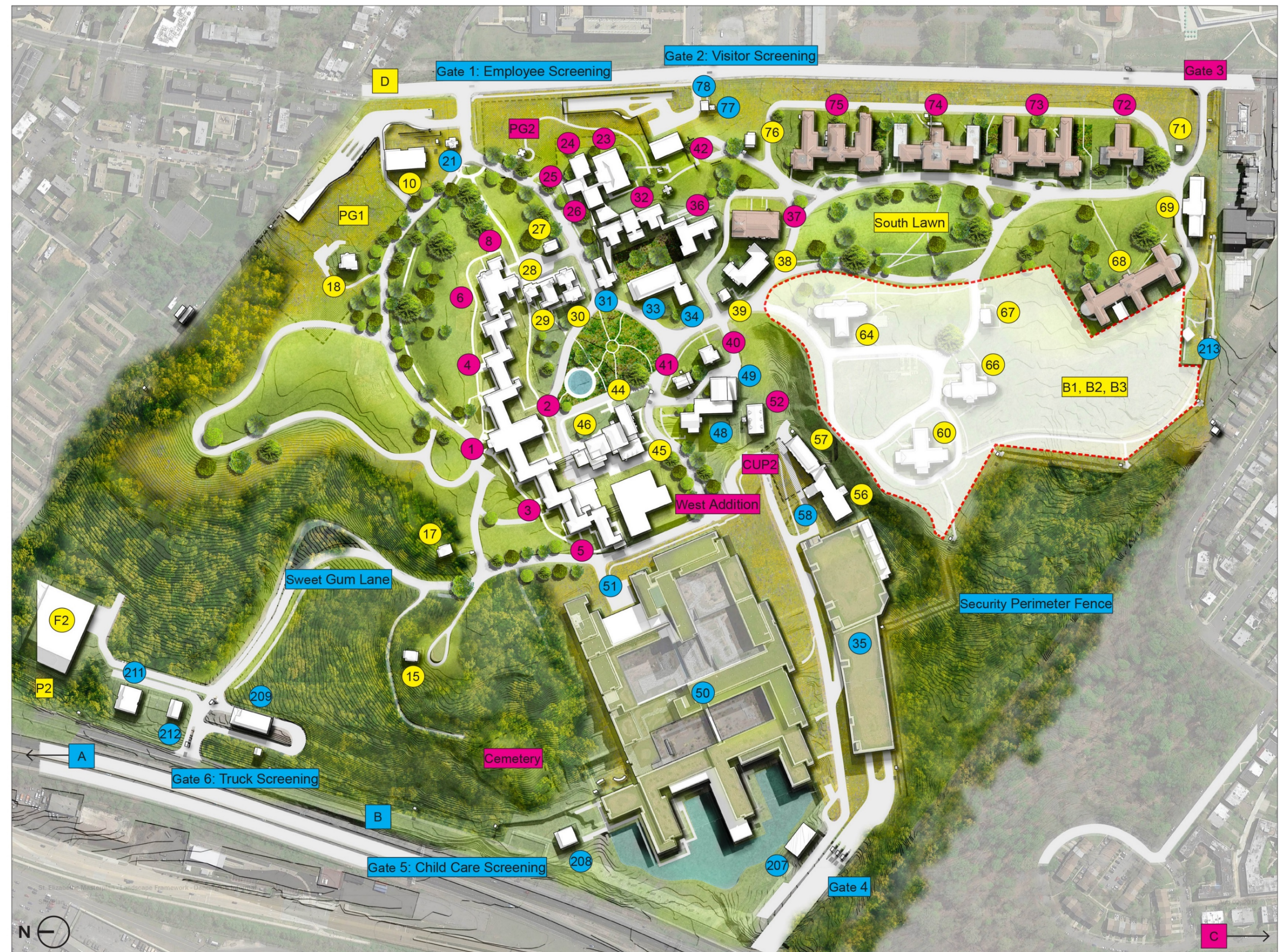

Department of Homeland Security Headquarters  
at St. Elizabeths





# Pavilion Site Development Design

## Concepts A, B, C

### PAVILION SITE CONCEPT ANALYSIS | PLANNING PRINCIPLES COMPARISON SUMMARY

#### TEST-FIT



Master Plan  
Width Test

#### 3 POTENTIAL CONCEPTS



Infill



Dancing Cs  
Terrace



Dancing Cs  
Layback



Site &  
Development  
Program

-

+

++

++



Historic  
Resources

See next page

See next page

See next page

See next page



Campus  
Landscape

-

+

++

++



Site Access

-

=

=

=



Department of Homeland Security Headquarters  
at St. Elizabeths

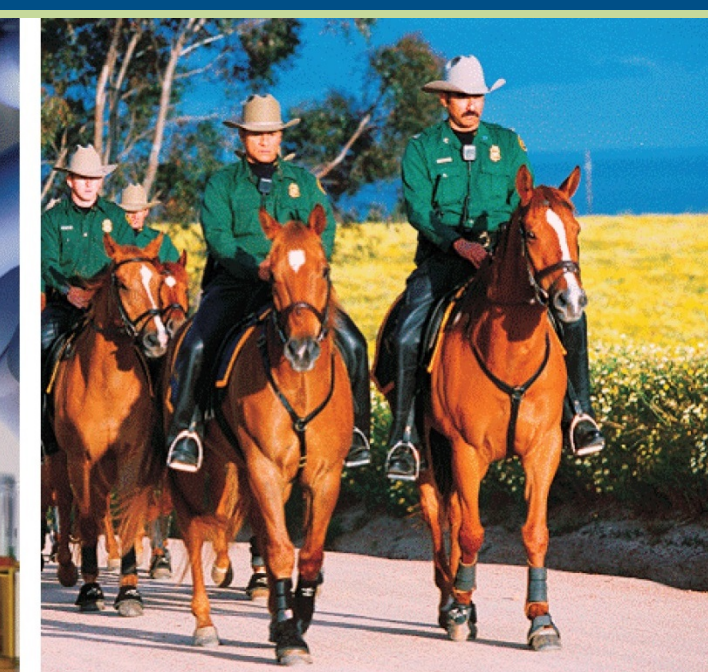



# Pavilion Site Development Design

## Concepts A, B, C

### PAVILION SITE CONCEPT ANALYSIS | INFLUENCES COMPARISON SUMMARY

#### TEST-FIT



**Master Plan  
Width Test**

#### 3 POTENTIAL CONCEPTS



**Infill**



**Dancing Cs  
Terrace**



**Dancing Cs  
Layback**



#### Adaptive Reuse\*

3 reused (60, 64, 66)  
1 removed (67)

3 reused (60, 64, 66)  
1 removed (67)

1 reused (64)  
1 relocated (60 or 66)  
2 removed (67 + 60 or 66)

1 reused (64)  
3 removed (60, 66, 67)  
(or 1 may also be relocated)



#### Slope & Soils

piles

terrace

terrace

layback



#### Planning & Identity

3-bay bar width,  
5 building identity

3-bay bar width,  
3 building identity

3-bay bar width,  
3 building identity

3-bay bar width,  
3 building identity



#### Sustainability

-

-/+

+

+

\*Refers to attitude toward historic buildings #60, 64, and 66 and historic cottage #67.



Department of Homeland Security Headquarters  
at St. Elizabeths

